



Report of: **Service Director, Public Protection**

Meeting of	Date	Agenda Item	Ward(s)
Licensing Sub-Committee	9 February 2016		Finsbury Park

Delete as appropriate		Non-exempt
-----------------------	--	------------

**Subject:** PREMISES LICENCE NEW APPLICATION  
**RE:** Five Four Ate, 548 Holloway Road, Road, London, N7 6JP

**1. Synopsis**

- 1.1 This is an application for a new premise licence under the Licensing Act 2003.
- 1.2 The new application is to:
  - The on sale of alcohol at the premises on Monday to Sunday from 10:00 to 21:00.

**2. Relevant Representations**

Licensing Authority	No
Metropolitan Police	No
Noise	No
Health and Safety	No
Trading Standards	No
Public Health	No
Safeguarding Children	No

London Fire Brigade	No
Local residents	Yes - One
Other bodies	No:

**3. Background**

3.1 Papers are attached as follows:-

- Appendix 1: application form;
- Appendix 2: representations;
- Appendix 3: suggested conditions and map of premises location.

**4. Planning Implications**

4.1 The planning department premises have confirmed that there is lawful planning use for this licence application.

**5 Recommendations**

5.1 To determine the application for a new premises licence under Section 17 of the Licensing Act 2003.

5.2 If the Committee grants the application it should be subject to:

- i. conditions prepared by the Licensing Officer which are consistent with the Operating Schedule (see appendix 3)
- ii. any conditions deemed appropriate by the Committee to promote the four licensing objectives.(see appendix 3)

**6 Conclusion and reasons for recommendations**

6.1 The Council is required to consider this application in the light of all relevant information, and if approval is given, it may attach such conditions as appropriate to promote the licensing objectives.

**Background papers:**

- The Council's Statement of Licensing Policy
- Licensing Act 2003
- Secretary of States Guidance

**Final Report Clearance**

Signed by

  
Service Director – Public Protection

Date 28/1/16

Received by

Head of Scrutiny and Democratic Services

Date

Report author: Licensing Service

Tel: 020 75027 3031

E-mail: [licensing@islington.gov.uk](mailto:licensing@islington.gov.uk)

# [L.B of Islington Council, Licensing Team]

## Application for a premises licence to be granted under the Licensing Act 2003

### PLEASE READ THE FOLLOWING INSTRUCTIONS FIRST

Before completing this form please read the guidance notes at the end of the form. If you are completing this form by hand please write legibly in block capitals. In all cases ensure that your answers are inside the boxes and written in black ink. Use additional sheets if necessary.

You may wish to keep a copy of the completed form for your records.

I/We Ufuk Cosgun

*(Insert name(s) of applicant)*

apply for a premises licence under section 17 of the Licensing Act 2003 for the premises described in Part 1 below (the premises) and I/we are making this application to you as the relevant licensing authority in accordance with section 12 of the Licensing Act 2003

#### Part 1 – Premises Details

Postal address of premises or, if none, ordnance survey map reference or description Five Four Ate 548 Holloway Road			
Post town	London	Postcode	N7 6JP

Telephone number at premises (if any)	
Non-domestic rateable value of premises	£ 17750

#### Part 2 - Applicant Details

Please state whether you are applying for a premises licence as

Please tick as appropriate

- a) an individual or individuals \*  please complete section (A)
- b) a person other than an individual \*
- i. as a limited company  please complete section (B)
- ii. as a partnership  please complete section (B)
- iii. as an unincorporated association or  please complete section (B)
- iv. other (for example a statutory corporation)  please complete section (B)

- c) a recognised club  please complete section (B)
- d) a charity  please complete section (B)
- e) the proprietor of an educational establishment  please complete section (B)
- f) a health service body  please complete section (B)
- g) a person who is registered under Part 2 of the Care Standards Act 2000 (c14) in respect of an independent hospital in Wales  please complete section (B)
- ga) a person who is registered under Chapter 2 of Part 1 of the Health and Social Care Act 2008 (within the meaning of that Part) in an independent hospital in England  please complete section (B)
- h) the chief officer of police of a police force in England and Wales  please complete section (B)

\* If you are applying as a person described in (a) or (b) please confirm:

Please tick yes

I am carrying on or proposing to carry on a business which involves the use of the premises for licensable activities; or

I am making the application pursuant to a  
 statutory function or   
 a function discharged by virtue of Her Majesty's prerogative

**(A) INDIVIDUAL APPLICANTS** (fill in as applicable)

Mr <input checked="" type="checkbox"/>	Mrs <input type="checkbox"/>	Miss <input type="checkbox"/>	Ms <input type="checkbox"/>	Other Title (for example, Rev)	
Surname Cosgun			First names Ufuk		
I am 18 years old or over				<input checked="" type="checkbox"/>	Please tick yes
Current post address different from above address					
Post town					
Daytime contact telephone number					
E-mail address (optional)					

**SECOND INDIVIDUAL APPLICANT (if applicable)**

Mr <input type="checkbox"/>	Mrs <input type="checkbox"/>	Miss <input type="checkbox"/>	Ms <input type="checkbox"/>	Other Title (for example, Rev)	
Surname			First names		
I am 18 years old or over				<input type="checkbox"/>	Please tick yes
Current postal address if different from premises address					
Post town		Postcode			
Daytime contact telephone number					
E-mail address (optional)					

**(B) OTHER APPLICANTS**

**Please provide name and registered address of applicant in full. Where appropriate please give any registered number. In the case of a partnership or other joint venture (other than a body corporate), please give the name and address of each party concerned.**

Name
Address
Registered number (where applicable)
Description of applicant (for example, partnership, company, unincorporated association etc.)
Telephone number (if any)
E-mail address (optional)

**Part 3 Operating Schedule**

When do you want the premises licence to start?

DD	MM	YYYY
2	3	1 2 2 0 1 5

If you wish the licence to be valid only for a limited period, when do you want it to end?

DD	MM	YYYY

Please give a general description of the premises (please read guidance note 1)

Café

If 5,000 or more people are expected to attend the premises at any one time, please state the number expected to attend.

What licensable activities do you intend to carry on from the premises?

(Please see sections 1 and 14 of the Licensing Act 2003 and Schedules 1 and 2 to the Licensing Act 2003)

Provision of regulated entertainment

Please tick any that apply

- a) plays (if ticking yes, fill in box A)
- b) films (if ticking yes, fill in box B)
- c) indoor sporting events (if ticking yes, fill in box C)
- d) boxing or wrestling entertainment (if ticking yes, fill in box D)
- e) live music (if ticking yes, fill in box E)
- f) recorded music (if ticking yes, fill in box F)
- g) performances of dance (if ticking yes, fill in box G)
- h) anything of a similar description to that falling within (e), (f) or (g) (if ticking yes, fill in box H)

**Provision of late night refreshment** (if ticking yes, fill in box I)

**Supply of alcohol** (if ticking yes, fill in box J)

In all cases complete boxes K, L and M

**A**

Plays Standard days and timings (please read guidance note 6)			<b>Will the performance of a play take place indoors or outdoors or both – please tick</b> (please read guidance note 2)	Indoors	<input type="checkbox"/>
Day	Start	Finish		Outdoors	<input type="checkbox"/>
				Both	<input type="checkbox"/>
Mon			<b>Please give further details here</b> (please read guidance note 3)		
Tue			<b>State any seasonal variations for performing plays</b> (please read guidance note 4)		
Wed			<b>Non standard timings. Where you intend to use the premises for the performance of plays at different times to those listed in the column on the left, please list</b> (please read guidance note 5)		
Thur					
Fri					
Sat					
Sun					



**B**

<b>Films</b> Standard days and timings (please read guidance note 6)			<b><u>Will the exhibition of films take place indoors or outdoors or both – please tick</u></b> (please read guidance note 2)	Indoors	<input type="checkbox"/>			
				Outdoors	<input type="checkbox"/>			
				Both	<input type="checkbox"/>			
<b>Day</b>	<b>Start</b>	<b>Finish</b>	<b><u>Please give further details here</u></b> (please read guidance note 3)					
Mon								
Tue								
Wed						<b><u>State any seasonal variations for the exhibition of films</u></b> (please read guidance note 4)		
Thur								
Fri						<b><u>Non standard timings. Where you intend to use the premises for the exhibition of films at different times to those listed in the column on the left, please list</u></b> (please read guidance note 5)		
Sat								
Sun								

C

<b>Indoor sporting events</b> Standard days and timings (please read guidance note 6)			<b><u>Please give further details</u></b> (please read guidance note 3)
Day	Start	Finish	
Mon			<b><u>State any seasonal variations for indoor sporting events</u></b> (please read guidance note 4)
Tue			
Wed			<b><u>Non standard timings. Where you intend to use the premises for indoor sporting events at different times to those listed in the column on the left, please list</u></b> (please read guidance note 5)
Thur			
Fri			
Sat			
Sun			

**D**

<b>Boxing or wrestling entertainments</b> Standard days and timings (please read guidance note 6)			<b><u>Will the boxing or wrestling entertainment take place indoors or outdoors or both – please tick</u></b> (please read guidance note 2)	Indoors	<input type="checkbox"/>
				Outdoors	<input type="checkbox"/>
Day	Start	Finish		Both	<input type="checkbox"/>
Mon			<b><u>Please give further details here</u></b> (please read guidance note 3)		
Tue					
Wed			<b><u>State any seasonal variations for boxing or wrestling entertainment</u></b> (please read guidance note 4)		
Thur					
Fri			<b><u>Non standard timings. Where you intend to use the premises for boxing or wrestling entertainment at different times to those listed in the column on the left, please list</u></b> (please read guidance note 5)		
Sat					
Sun					

**E**

<b>Live music</b> Standard days and timings (please read guidance note 6)			<b>Will the performance of live music take place indoors or outdoors or both – please tick</b> (please read guidance note 2)	Indoors	<input type="checkbox"/>
				Outdoors	<input type="checkbox"/>
Day	Start	Finish		Both	<input type="checkbox"/>
Mon			<b>Please give further details here</b> (please read guidance note 3)		
Tue					
Wed			<b>State any seasonal variations for the performance of live music</b> (please read guidance note 4)		
Thur					
Fri			<b>Non standard timings. Where you intend to use the premises for the performance of live music at different times to those listed in the column on the left, please list</b> (please read guidance note 5)		
Sat					
Sun					

**F**

<b>Recorded music</b> Standard days and timings (please read guidance note 6)			<b><u>Will the playing of recorded music take place indoors or outdoors or both – please tick</u></b> (please read guidance note 2)	Indoors	<input type="checkbox"/>
				Outdoors	<input type="checkbox"/>
				Both	<input type="checkbox"/>
<b>Day</b>	<b>Start</b>	<b>Finish</b>	<b><u>Please give further details here</u></b> (please read guidance note 3)		
Mon					
Tue					
<b>Wed</b>			<b><u>State any seasonal variations for the playing of recorded music</u></b> (please read guidance note 4)		
Thur					
<b>Fri</b>			<b><u>Non standard timings. Where you intend to use the premises for the playing of recorded music at different times to those listed in the column on the left, please list</u></b> (please read guidance note 5)		
Sat					
Sun					

**G**

<b>Performances of dance</b> Standard days and timings (please read guidance note 6)			<b><u>Will the performance of dance take place indoors or outdoors or both – please tick</u></b> (please read guidance note 2)	Indoors	<input type="checkbox"/>
				Outdoors	<input type="checkbox"/>
				Both	<input type="checkbox"/>
<b>Day</b>	<b>Start</b>	<b>Finish</b>	<b><u>Please give further details here</u></b> (please read guidance note 3)		
Mon					
Tue					
			<b><u>State any seasonal variations for the performance of dance</u></b> (please read guidance note 4)		
Wed					
Thur					
			<b><u>Non standard timings. Where you intend to use the premises for the performance of dance at different times to those listed in the column on the left, please list</u></b> (please read guidance note 5)		
Fri					
Sat					
Sun					



I

<b>Late night refreshment</b> Standard days and timings (please read guidance note 6)			<b>Will the provision of late night refreshment take place indoors or outdoors or both – please tick</b> (please read guidance note 2)	Indoors	<input type="checkbox"/>
Day	Start	Finish		Outdoors	<input type="checkbox"/>
				Both	<input type="checkbox"/>
Mon				<b><u>Please give further details here</u></b> (please read guidance note 3)	
Tue					
Wed			<b><u>State any seasonal variations for the provision of late night refreshment</u></b> (please read guidance note 4)		
Thur			<b><u>Non standard timings. Where you intend to use the premises for the provision of late night refreshment at different times, to those listed in the column on the left, please list</u></b> (please read guidance note 5)		
Fri					
Sat					
Sun					



**J**

<b>Supply of alcohol</b> Standard days and timings (please read guidance note 6)			<b>Will the supply of alcohol be for consumption – please tick</b> (please read guidance note 7)	On the premises	<input checked="" type="checkbox"/>
				Off the premises	<input type="checkbox"/>
				Both	<input type="checkbox"/>
<b>Day</b>	<b>Start</b>	<b>Finish</b>	<b>State any seasonal variations for the supply of alcohol</b> (please read guidance note 4)		
Mon	09:00	21:00			
Tue	09:00	21:00			
Wed	09:00	21:00			
Thur	09:00	21:00			
Fri	09:00	21:00			
Sat	09:00	21:00			
Sun	09:00	21:00			
			<b>Non standard timings. Where you intend to use the premises for the supply of alcohol at different times to those listed in the column on the left, please list</b> (please read guidance note 5)		

**State the name and details of the individual whom you wish to specify on the licence as designated premises supervisor:**

<b>Personal licence number (if known)</b>	
<b>Application in progress</b>	
<b>Issuing licensing authority (if known)</b>	
<b>L.B of Haringey</b>	

K

**Please highlight any adult entertainment or services, activities, other entertainment or matters ancillary to the use of the premises that may give rise to concern in respect of children (please read guidance note 8).**

L

<b>Hours premises are open to the public</b> Standard days and timings (please read guidance note 6)			<b>State any seasonal variations</b> (please read guidance note 4)
Day	Start	Finish	
Mon	06:30	21:00	<p><b><u>Non standard timings. Where you intend the premises to be open to the public at different times from those listed in the column on the left, please list</u></b> (please read guidance note 5)</p>
Tue	06:30	21:00	
Wed	06:30	21:00	
Thur	06:30	21:00	
Fri	06:30	21:00	
Sat	06:30	21:00	
Sun	06:30	21:00	

**M** Describe the steps you intend to take to promote the four licensing objectives:

**a) General – all four licensing objectives (b, c, d and e) (please read guidance note 9)**

Strong management controls and effective training of all staff so that they are aware of the premises licence and the requirements to meet the four licensing objectives with particular attention to:

- a/ no selling of alcohol to underage people
- b/ no drunk and disorderly behavior on the premises area
- c/ vigilance in preventing the use and sale of illegal drugs at the retail area
- d/ no violent and anti-social behaviour
- e/ no any harm to children

- Operating Schedule providing the hours of operation and licensable activities during those hours.
- Designated premises supervisor confirmed it is obligated to be in day-to-day control of the premises, to provide good training for staff on the Licensing Act (Training Record), to make or authorize each sale
- Clear "Challenge 25" information to prevent the supply of alcohol to under-age drinkers.
- CCTV system installed with recording option available
- Roller metal exterior window shutter will be fixed to ensure that shop front is safe and secure at all times

**b) The prevention of crime and disorder**

CCTV System installed to monitor entrances, exits, and other parts of the premises in order to address the prevention of crime objective.

Not selling of alcohol to drunk or intoxicated customers.  
Can consider further conditions.

**c) Public safety**

Internal and external lighting fixed to promote the public safety objective.

Well trained staff adherence to environmental health requirements.

Training and implementation of underage ID checks.

A log book or recording system shall be kept upon the premises in which shall be entered particulars of inspections made; those required to be made by statute, and information compiled to comply with any public safety condition attached to the premises licence that requires the recording of such information. The log book shall be kept available for inspection when required by persons authorised by the Licensing Act 2003 or associated legislation.

**d) The prevention of public nuisance**

Prominent, clear and legible notices will be displayed at the exit requesting the public to respect the needs of nearby residents and to leave the premises and the area quietly.

Customers will be asked not to stand around loudly talking in the street outside the premises. Customers will not be admitted to premises above opening hours.

Any lighting on or outside the premises will be positioned and screened in such a way so as to not cause a disturbance to nearby residents.

**e) The protection of children from harm**

"Challenge 25" sign which is a retailing strategy that encourages anyone who is over 18 but looks under 25 to carry acceptable ID (a card bearing the PASS hologram, a photographic driving license or a passport) if they wish to buy alcohol.

Well trained staff about requirement for persons' identification, age establishment etc.

All the details provided in Training Record Book available the retail unit.

Log Book will be kept upon the premises all the time.

**Checklist:**

Please tick to indicate agreement

- I have made or enclosed payment of the fee.
- I have enclosed the plan of the premises.
- I have sent copies of this application and the plan to responsible authorities and others where applicable.
- I have enclosed the consent form completed by the individual I wish to be designated premises supervisor, if applicable.
- I understand that I must now advertise my application.
- I understand that if I do not comply with the above requirements my application will be rejected.

**IT IS AN OFFENCE, LIABLE ON SUMMARY CONVICTION TO A FINE NOT EXCEEDING LEVEL 5 ON THE STANDARD SCALE, UNDER SECTION 158 OF THE LICENSING ACT 2003, TO MAKE A FALSE STATEMENT IN OR IN CONNECTION WITH THIS APPLICATION.**

**Part 4 – Signatures** (please read guidance note 10)

Signature of applicant or applicant's solicitor or other duly authorised agent (see guidance note 11). If signing on behalf of the applicant, please state in what capacity.

Signature	U. Cosgun
Date	24.11.2015
Capacity	Ufuk Cosgun (Premises Business Owner)

For joint applications, signature of 2<sup>nd</sup> applicant or 2<sup>nd</sup> applicant's solicitor or other authorised agent (please read guidance note 12). If signing on behalf of the applicant, please state in what capacity.

Signature	
Date	
Capacity	

Contact name (where not previously given) and postal address for correspondence associated with this application (please read guidance note 13)

Miss Yuksel Uyran



Post town	London
-----------	--------

Postcode	N17 0HE
----------	---------

Telephone number (if any)	[Redacted]
---------------------------	------------

If you would prefer us to correspond with you by e-mail, your e-mail address (optional)



## Notes for Guidance

1. Describe the premises, for example the type of premises, its general situation and layout and any other information which could be relevant to the licensing objectives. Where your application includes off-supplies of alcohol and you intend to provide a place for consumption of these off-supplies, you must include a description of where the place will be and its proximity to the premises.
2. Where taking place in a building or other structure please tick as appropriate (indoors may include a tent).
3. For example the type of activity to be authorised, if not already stated, and give relevant further details, for example (but not exclusively) whether or not music will be amplified or unamplified.
4. For example (but not exclusively), where the activity will occur on additional days during the summer months.
5. For example (but not exclusively), where you wish the activity to go on longer on a particular day e.g. Christmas Eve.
6. Please give timings in 24 hour clock (e.g. 16:00) and only give details for the days of the week when you intend the premises to be used for the activity.
7. If you wish people to be able to consume alcohol on the premises, please tick 'on the premises'. If you wish people to be able to purchase alcohol to consume away from the premises, please tick 'off the premises'. If you wish people to be able to do both, please tick 'both'.
8. Please give information about anything intended to occur at the premises or ancillary to the use of the premises which may give rise to concern in respect of children, regardless of whether you intend children to have access to the premises, for example (but not exclusively) nudity or semi-nudity, films for restricted age groups or the presence of gaming machines.
9. Please list here steps you will take to promote all four licensing objectives together.
10. The application form must be signed.
11. An applicant's agent (for example solicitor) may sign the form on their behalf provided that they have actual authority to do so.
12. Where there is more than one applicant, each of the applicant or their respective agent must sign the application form.
13. This is the address which we shall use to correspond with you about this application.

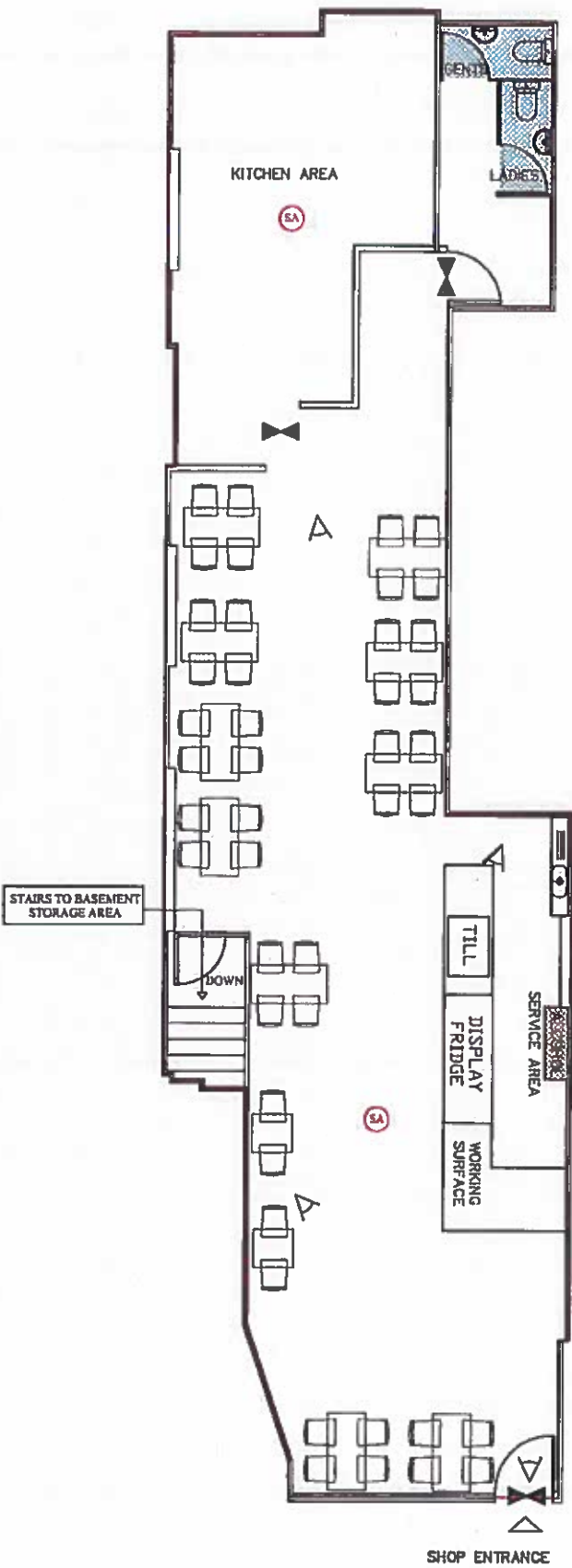

**LEGEND**

-  FIRE ALARM BELL
-  ALCOHOL
-  WC AREA
-  AMBIT OF LICENSED PREMISES
-  SAFETY LIGHTS
-  SMOKE DETECTOR
-  CCTV
-  CARBON DIOXIDE FIRE EXTINGUISHER
-  9 LT. WATER FIRE EXTINGUISHER
-  FIRE BLANKETS

AMENDMENTS	
A	
B	
C	
D	
E	
<p><b>FIVE FOUR ATE</b>            548 HOLLOWAY ROAD            N7 6JP</p>	
<p>PROPOSED            - GROUND FLOOR PLAN</p>	
SCALE 1/100 @A4	Date : 02 NOVEMBER 15
<p>Ref.No : 5411</p>	

-----Original Message-----

From:

Sent: 16 December 2015 15:51

To: Licensing

Subject: WK/201606219

Dear Niall,

Thank you for writing to us about a new licensing application at FIVE FOUR ATE, 548 Holloway Road.

I am not comfortable about extending this new license because ever since we have allowed the new student accommodation to be built near N7 6JN, we have seen an increase of drunken young men and women in the neighbourhood, rodents in our flats (thanks to students throwing pizza boxes out of the window, etc.) and general unease in terms of public safety in the area. I don't think we need another licensed place to encourage drinking by the students and others.

In addition, the license itself is from 9am until 9pm Monday - Sunday - it is unacceptable.

Please do not grant this new license.

Best wishes,

**Suggested conditions of approval consistent with the operating schedule**

1. The licence holder shall have management controls and effective training of all staff so that they are all aware of the both the conditions of the premises licence and all four of the licensing objectives.
2. This training shall have specific attention to;
  - a) No selling of alcohol to underage persons
  - b) No drunk and disorderly behaviour on the premises
  - c) Vigilance in preventing the use and sale illegal drugs in the retail area
  - d) No violent and anti – social behaviour
  - e) No harm to children
3. A roller metal exterior window shutter will be fixed to ensure that shop front is safe and secure at all times
4. Internal and external lighting fixed to promote public safety.
5. Staff shall be well trained to comply with environmental health requirements.
6. All staff shall be trained in the implementation of underage ID checks.
7. A log book or electronic recording system shall be kept on the premises in which shall be entered particulars of inspections made, those required to be made by statute, and information complied to comply with any public safety condition attached to the premises licence that requires the recording of such information. The log book shall be kept available for inspection when required by persons authorised by the Licensing Act 2003 or associated legislation.
8. Prominent, clear and legible notices will be displayed at the exit requesting the public to respect the needs of nearby residents and to leave the premises and area quietly.
9. Customers will be asked not to stand around loudly talking in the street outside the premises. Customers will not be admitted to the premises outside of opening hours.
10. All lighting on or outside the premises will be positioned and screened in such a way so as to not cause a disturbance to nearby residents.
11. "Challenge 25" shall be enforced at the premises.
12. All staff shall be fully trained in the challenge 25 scheme.
13. All details of refusal and staff training shall be kept in a log book at the premises at all times, and this log book this shall be made available to officers on request.

**Conditions proposed by the Metropolitan Police**

14. CCTV shall be installed, operated and maintained in agreement with the Police. Maintained means that the system will be regularly serviced (at least once a year) and checked every two weeks to ensure that it is storing images correctly and a log kept and signed by a supervisor to this effect. The system will provide identifiable full frontal head and shoulder image of everyone entering the premises and will operate in any light conditions within the premises. The system will cover the full exterior of the premises and shall record in real time, date and time stamped and will operate whilst the premises is open for licensable activities. The recordings will be kept for a minimum of 31 days and copies will be made available to an Authorised officer or a police officer (subject to the Data protection Act 1998) within 24hrs of any request free of charge. There will always be a member of staff on duty who can



operate the system, to allow officers to view recordings and if required by a Police Officer, provide a copy of images immediately free of charge to assist in the immediate investigation of offences. If the system malfunctions and will not be operating for longer than one day of business then Police must be informed

15. The supply of alcohol at the premises shall only be to a person seated taking a table meal there and for consumption by such a person as ancillary to their meal
16. The supply of alcohol shall be by waiter or waitress service only

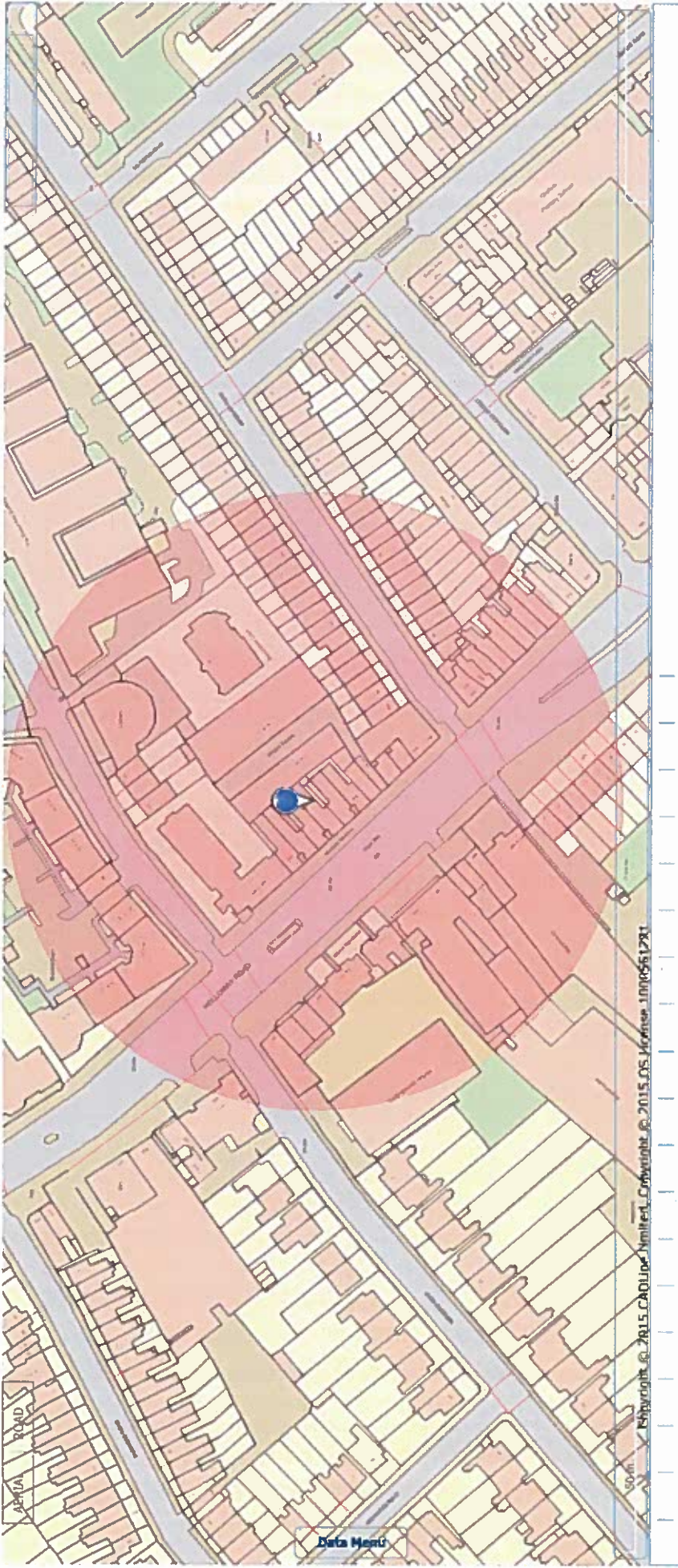

Contact Us | About GIS Team | Data Library

© Copyright 2013 Cadline Limited V3